

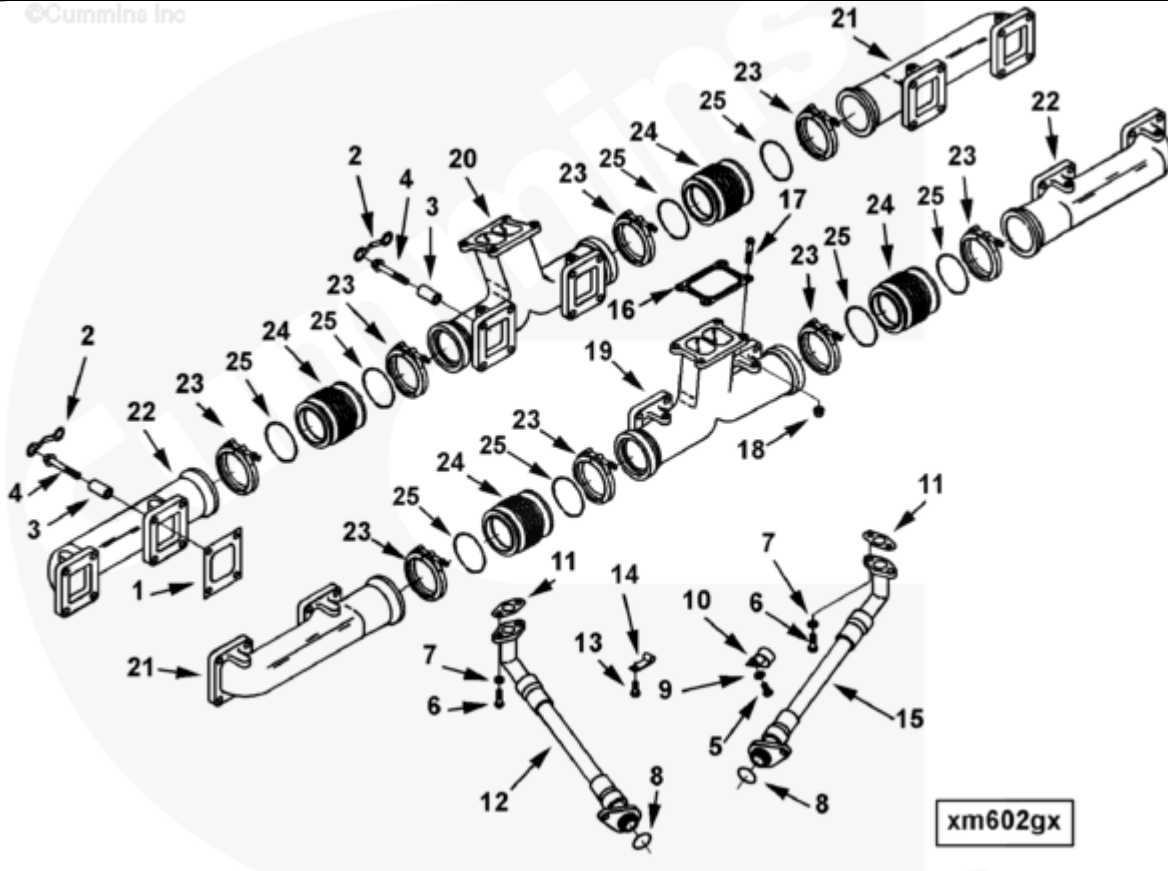

## Parts Catalog - Option Detail

Electronic Parts Catalog - Option Detail				
Option	Group	Graphic	Film Card	Date
XM6057-03	11.01	xm602gx	K38	26-NOV-03
<b>Engines</b>	GTA38, K38, KTA38GC CM558, QSK38 CM2150 K106, QSK38 CM2150 MCRS, QSK38 CM850 MCRS			

©Cummins Inc



[SMALL](#) | [MEDIUM](#) | [LARGE](#)

Cart	Ref No	Part Number	Part Description	Required	Remarks
<a href="#">View My Cart</a>					
		XM6057-03	Exhaust Manifold		<a href="#">Dry pulse bellows exhaust for...(More)</a>
					KT38 engine with center
					mounted turbocharger chargers
					and outboard aftercoolers
					arrangement. Exhaust outlet
					to the rear of the engine.

<input type="checkbox"/>	1	<a href="#">3966349</a>	Exhaust Manifold Gasket	12	
<input type="checkbox"/>	2	<a href="#">3628969</a>	Lock Plate	24	
<input type="checkbox"/>	3	<a href="#">3046287</a>	Mounting Spacer	48	
<input type="checkbox"/>	4	<a href="#">3631163</a>	Hexagon Flange Head Cap Screw	48	
<input type="checkbox"/>	5	<a href="#">S 117</a>	Hexagon Head Cap Screw	2	3/8 - 16 x 3/4 in.
<input type="checkbox"/>	6	<a href="#">S 172 B</a>	Hexagon Head Cap Screw	4	3/8 - 16 X 1 1/8 in.
<input type="checkbox"/>	7	<a href="#">S 604</a>	Lock Washer	4	3/8 in.
<input type="checkbox"/>	8	<a href="#">216187</a>	O-Ring Seal	2	
<input type="checkbox"/>	9	<a href="#">3628902</a>	Plain Washer	2	
<input type="checkbox"/>	10	<a href="#">3629451</a>	Clip	1	
<input type="checkbox"/>	11	<a href="#">3630742</a>	Connection Gasket	2	
<input type="checkbox"/>	12	<a href="#">3632339</a>	Flexible Hose	1	
<input type="checkbox"/>	13	<a href="#">S 109</a>	Hexagon Head Cap Screw	1	3/8 - 16 x 7/8 in.
<input type="checkbox"/>	14	<a href="#">3175058</a>	Clip	1	
<input type="checkbox"/>	15	<a href="#">3632338</a>	Flexible Hose	1	
<input type="checkbox"/>	16	<a href="#">3171368</a>	Turbocharger Gasket	2	
<input type="checkbox"/>	17	<a href="#">3176570</a>	Hexagon Flange Head Cap Screw	8	3/8 - 24 X 1 7/8 Inch.
<input type="checkbox"/>	18	<a href="#">3626804</a>	Lock Nut	8	3/8 - 24 UNF.
<input type="checkbox"/>	19	<a href="#">3633723</a>	Exhaust Manifold	1	
<input type="checkbox"/>	20	<a href="#">3633724</a>	Exhaust Manifold	1	
<input type="checkbox"/>	21	<a href="#">3633733</a>	Exhaust Manifold	2	
<input type="checkbox"/>	22	<a href="#">3633734</a>	Exhaust Manifold	2	
<input type="checkbox"/>	23	<a href="#">3634052</a>	V Band Clamp	8	
<input type="checkbox"/>	24	<a href="#">3968643</a>	Bellows	4	
<input type="checkbox"/>	25	<a href="#">3966350</a>	Exhaust Clamp Seal	8	